

Data Sheet

Weld-in Thermowells

FEATURES

- One piece bar stock construction
- Stamped with mill traceable material and heat number
- Testing and certifications including Wake Frequency Calculations per ASME PTC 19.3 TW-2016
- Standard or customized shank dimensions

TYPICAL USES

- Chemical and Petrochemical Plants
- Water and Wastewater Pressure Control
- Pharmaceutical / Biotech
- Food and Beverages



Weld-in Thermowells
1 1/2" weld-in sizes

SPECIFICATIONS

Shank Style:	Tapered
Process Connection:	1 1/2"
Instrument Connection:	1/2 NPSM, 1/2 NPT Female
Bore Size:	0.260", 0.385"
Surface Finish:	16-32 RA
Lagging:	2": if U-dimension is <3" 3": if U-dimension is >3"
Cap and Chain:	Brass, Stainless steel

TABLE 1

OPTIONS	CODE
Stamp tag number on thermowell	NF
Stainless steel tag wired to thermowell	NH
Hydrostatic test-internal	W9
Clean for oxygen service	6B
Wake frequency calculation	W5
Material origin restriction	UM

Certificates

Certificate of Conformance (per order)	CD-1A
Physical and Chemical Material Test Report (MTR's)	W6
Positive Material Identification (PMI) N/A Carbon Steel	MQ
NACE Certificate of Compliance	CD-5

KEY BENEFITS

- Protects instrument against corrosive effects and physical damage caused by media flow
- Permits instrument interchange or calibration check without disturbing/closing down the process
- Tracing of material origin for quality assurance and control

TABLE 2

MATERIALS	CODE
304 Stainless steel	C
316 Stainless steel	S
Monel®	M
Hastelloy B/C	G/H
Carpenter 20	D
Chrome Moly F11/F22	FA/FB
Duplex 2205 S/S	J
Super Duplex S32750	SD
Inconel 600	W
Titanium	TI
Carbon Steel	B

Data Sheet

Weld-in Thermowells

ORDERING CODE	Example:	15	W	0450	L	H	W	260	SL	1	XNF	L0350
Process Connection Size												
15 - 1½"		15										
Thermowell												
W - Thermowell			W									
U-Process Insertion Length												
0250 - 2½"												
0450 - 4½"				0450								
0750 - 7½"												
1050 - 10½"												
1350 - 13½"												
1650 - 16½"												
2250 - 22½"												
Instrument Connection												
Blank - ½ NPSM												
2 - ½ NPT Female												
T-Lagging												
Blank - No lagging												
L - Lagging (For special lag length, see below)					L							
Shank Type												
H - Tapered						H						
Process Connection												
W - Weld in							W					
D-Bore Diameter												
260 - 0.260"								260				
385 - 0.385"												
Material (Refer to Table 2)												
CL - 304 Stainless steel												
SL - 316 Stainless steel									SL			
Cap and Chain												
Blank - No cap and chain												
1 - Brass										1		
2 - Stainless steel												
Options - (see Table 1 on page 1 for additional options (If choosing an option(s) must include an "X")											X	
NF - Stamp tag number on thermowell												NF
Special Lagging Length												
L - Lagging length × 100 (ex: 3.5" × 100 = L0350)												L0350

Weld-in Thermowells

DIMENSIONS

For reference only, consult Ashcroft for specific dimensional drawings

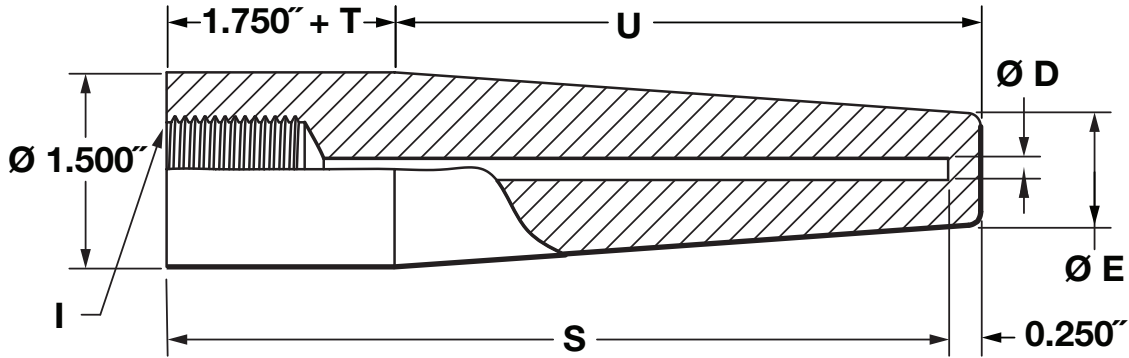

DIMENSION (Inches)	
S	U
4	2½
6	4½
9	7½
12	10½
15	13½
18	16½
24	22½

Weld-In	
D	E
0.260"	0.625"
0.385"	0.766"

Thermowell Legend

I - Instrument connection (½" NPSM STD.)

E - Tip O.D.

D - Bore diameter

U - Insertion depth

S - Instrument stem length or bore depth