

Data Sheet

Socket Weld Thermowells

FEATURES

- One piece bar stock construction
- Stamped with mill traceable material and heat number
- Testing and certifications including Wake Frequency Calculations per ASME PTC 19.3 TW-2016
- Standard or customized shank dimensions

TYPICAL USES

- Chemical and Petrochemical Plants
- Water and Wastewater Pressure Control
- Pharmaceutical / Biotech
- Food and Beverages



Socket Weld Thermowells

¾", 1" socket weld sizes

SPECIFICATIONS

Shank Style: Tapered, straight, or stepped

Process Connection: ¾", 1"

Instrument Connection: ½ NPSM, ½ NPT Female

Bore Size: 0.260", 0.385"

Surface Finish: 16-32 RA

Lagging: 2": if U-dimension is <3"
3": if U-dimension is >3"

Cap and Chain: Brass, Stainless steel

TABLE 1

| OPTIONS | CODE |
|--------------------------------|------|
| Stamp tag number on thermowell | NF |
| SS tag wired to thermowell | NH |
| Hydrostatic test-internal | W9 |
| Clean for oxygen service | 6B |
| Wake frequency calculation | W5 |
| Material origin restriction | UM |

Certificates

| | |
|---|-------|
| Certificate of Conformance (per order) | CD-1A |
| Physical and Chemical Material Test Report (MTR's) | W6 |
| Positive Material Identification (PMI) N/A Carbon Steel | MQ |
| NACE Certificate of Compliance | CD-5 |

KEY BENEFITS

- Protects instrument against corrosive effects and physical damage caused by media flow
- Permits instrument interchange or calibration check without disturbing/closing down the process
- Tracing of material origin for quality assurance and control

TABLE 2

| MATERIALS | CODE |
|---------------------|-------|
| 304 Stainless steel | C |
| 316 Stainless steel | S |
| Monel® | M |
| Hastelloy B/C | G/H |
| Carpenter 20 | D |
| Chrome Moly F11/F22 | FA/FB |
| Duplex 2205 S/S | J |
| Super Duplex S32750 | SD |
| Iconel 600 | W |
| Titanium | TI |
| Carbon Steel | B |

Data Sheet

Socket Weld Thermowells

| ORDERING CODE | Example: | 75 | W | 0450 | L | H | S | 260 | S | 1 | XNF | L0350 |
|---|----------|----|------|------|---|---|---|-----|---|---|-------|-------|
| Process Connection Size | | | | | | | | | | | | |
| 75 - ¾" (socket weld only) | | 75 | | | | | | | | | | |
| 10 - 1" (socket weld only) | | | | | | | | | | | | |
| Thermowell | | | | | | | | | | | | |
| W - Thermowell | | | W | | | | | | | | | |
| U-Process Insertion Length | | | | | | | | | | | | |
| 0250 - 2½" | | | | | | | | | | | | |
| 0450 - 4½" | | | 0450 | | | | | | | | | |
| 0750 - 7½" | | | | | | | | | | | | |
| 1050 - 10½" | | | | | | | | | | | | |
| 1350 - 13½" | | | | | | | | | | | | |
| 1650 - 16½" | | | | | | | | | | | | |
| 2250 - 22½" | | | | | | | | | | | | |
| I-Instrument Connection | | | | | | | | | | | | |
| Blank - ½ NPSM | | | | | | | | | | | | |
| 2 - ½ NPT Female | | | | | | | | | | | | |
| T-Lagging | | | | | | | | | | | | |
| Blank - No lagging | | | | | | | | | | | | |
| L - Lagging (For special lag length, see below) | | | | | | L | | | | | | |
| Shank Type | | | | | | | | | | | | |
| H - Tapered | | | | | | H | | | | | | |
| S - Straight | | | | | | | | | | | | |
| R - Stepped | | | | | | | | | | | | |
| Process Connection | | | | | | | | | | | | |
| S - Socket weld | | | | | | | S | | | | | |
| D-Bore Diameter | | | | | | | | | | | | |
| 260 - 0.260" | | | | | | | | 260 | | | | |
| 385 - 0.385" | | | | | | | | | | | | |
| Material (Refer to Table 2) | | | | | | | | | | | | |
| C - 304 Stainless steel | | | | | | | | | | | | |
| S - 316 Stainless steel | | | | | | | | | S | | | |
| Cap and Chain | | | | | | | | | | | | |
| Blank - No cap and chain | | | | | | | | | | | | |
| 1 - Brass | | | | | | | | | | 1 | | |
| 2 - Stainless Steel | | | | | | | | | | | | |
| Options - (see Table 1 on page 1 for additional options (If choosing an option(s) must include an "X") | | | | | | | | | | | X__ | |
| NF - Stamp tag number on thermowell | | | | | | | | | | | NF | |
| Special Lagging Length | | | | | | | | | | | | |
| L - Lagging length × 100 (ex: 3.5" × 100 = L0350) | | | | | | | | | | | L0350 | |

Data Sheet

Socket Weld Thermowells

DIMENSIONS

For reference only, consult Ashcroft for specific dimensional drawings

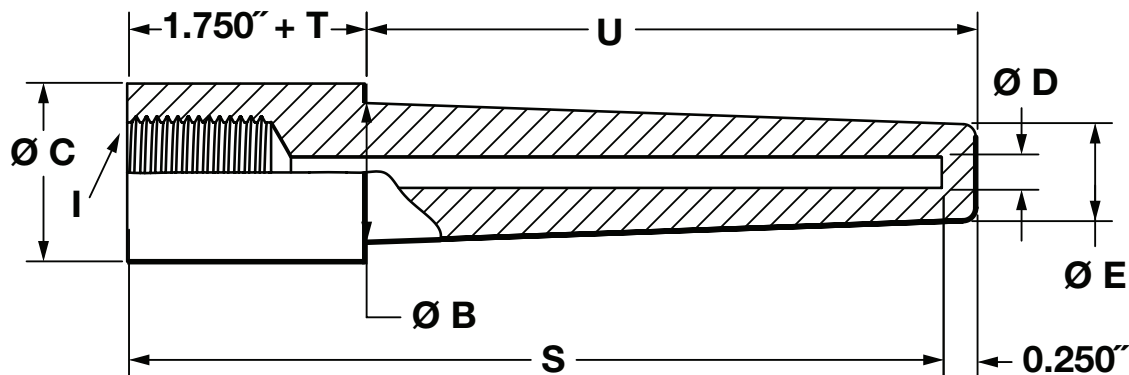

| DIMENSION (Inches) | | | PART NUMBER | |
|--------------------|----|--------|------------------------------|------------------------------|
| P | S | U | 1/4\" Bore | 3/8\" Bore |
| 3/4 1 | 4 | 2 1/2 | 75W0250HS260 10W0250HS260 | 75W0250HS385 10W0250HS385 |
| 3/4 1 | 6 | 4 1/2 | 75W0450HS260 10W0450HS260 | 75W0450HS385 10W0450HS385 |
| 3/4 1 | 9 | 7 1/2 | 75W0750HS260 10W0750HS260 | 75W0750HS385 10W0750HS385 |
| 3/4 1 | 12 | 10 1/2 | 75W1050HS260 10W1050HS260 | 75W1050HS385 10W1050HS385 |
| 3/4 1 | 15 | 13 1/2 | 75W1350HS260 10W1350HS260 | 75W1350HS385 10W1350HS385 |
| 3/4 1 | 18 | 16 1/2 | 75W1650HS260 10W1650HS260 | 75W1650HS385 10W1650HS385 |
| 3/4 1 | 24 | 22 1/2 | 75W2250HS260 10W2250HS260 | 75W2250HS385 10W2250HS385 |

| Socket Weld Tapered - 0.260 & 0.385 Bore | | | | | |
|--|--------|--------------------|--------------------|--------------------|--------------------|
| Pipe Size | C | B 0.260 Bore | B 0.385 Bore | E 0.260 Bore | E 0.385 Bore |
| 3/4" | 1.05" | 0.78" | 0.87" | 0.625" | 0.766" |
| 1" | 1.315" | 1.03" | 1.03" | 0.625" | 0.766" |

Thermowell Legend

I - Instrument connection (1/2" NPSM is STD.)

E - Tip O.D.

D - Bore diameter

U - Insertion depth

S - Instrument stem length or bore depth

C - Hub diameter

B - Root OD