

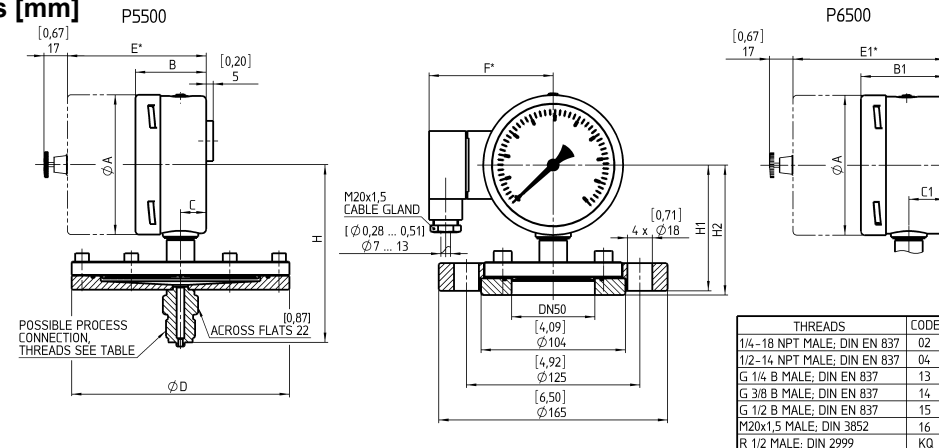

## General dimensions [mm]



\* WITH INTEGRATED CONTACTS

PRESSURE RANGE	SIZE	Φ A	B	B1	C	C1	Φ D	E*	E1*	F*	H
≥ 0,6 bar	100	[3,97]	[2,01]	[2,38]	[0,73]	[1,02]	[3,90]	[3,94]	[4,33]	[3,50]	[5,04]
	160	[6,35]	[1,96]	[2,52]	[0,76]	[1,11]	[3,90]	[3,94]	[4,49]	[4,69]	[6,22]
	160	[6,35]	[1,96]	[2,52]	[0,76]	[1,11]	[3,90]	[3,94]	[4,49]	[4,69]	[6,22]
< 400 mbar	100	[3,97]	[2,01]	[2,38]	[0,73]	[1,02]	[6,18]	[3,94]	[4,33]	[3,50]	[4,92]
	160	[6,35]	[1,96]	[2,52]	[0,76]	[1,11]	[6,18]	[3,94]	[4,49]	[4,69]	[6,10]
	160	[6,35]	[1,96]	[2,52]	[0,76]	[1,11]	[6,18]	[3,94]	[4,49]	[4,69]	[6,10]

RANGE	DN	Φ D1	Φ G	H3	Φ K	4 x M
DN20/PN40	100	[4,13]	[2,28]	[2,28]	[2,95]	M12
DN25/PN40	115	[4,53]	[2,68]	[2,68]	[3,35]	M16
DN50/PN40	165	[6,50]	[4,02]	[4,02]	[4,92]	M16
DN1" 150 lbs	108	[4,25]	[2,00]	[2,00]	[3,12]	1/2-13 UNC
DN1" 300 lbs	123,9	[4,88]	[2,00]	[2,00]	[3,50]	5/8-11 UNC
DN2" 150 lbs	152,4	[6,00]	[3,62]	[3,62]	[4,75]	1-11 UNC
DN3" 150 lbs	190,9	[7,52]	[5,00]	[5,00]	[6,00]	1-11 UNC

FLANGE DN50	SIZE	H1	H2
100	[4,61]	[4,72]	[117]
160	[5,79]	[5,91]	[147]

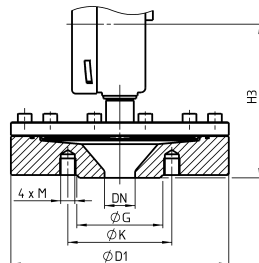

## Order information

Size	Type	System material	Execution	Process connection	Connection orientation	Range	Engineering units	Filling	Options
(100) 100 mm	P5500	(S) Diaphragm 316Ti (1.4571) or Duratherm or Inconel, flange 316L (1.4404)	(D) IP66	(02) ¼ NPT male	(L) Lower	-16/ 0	MBAR	(=) Standard no filling	(6B) Cleaned for Oxygen service
(160) 160 mm	P6500	(ST) Diaphragm 316Ti (1.4571) or Duratherm or Inconel, flange 316L (1.4404), PTFE-lined (accuracy class 2,5 [2,5 % F.S.], range >100 mbar, not for NPT threads)	(L) Liquid filled IP66 <sup>1)</sup>	(04) ½ NPT male		-400/ 0		(GR) Glycerin	(ATEX) ATEX approval
		(HS) Diaphragm Hastelloy C-276, flange 316L (1.4404) <sup>1)</sup>		(13) G ¼ B male		0/ 16		(GV) Silicone	(CS) Dual scale
				(14) G 3/8 B male		0/ 25		( ) Contact type and function (see data sheet G1.K55/E) <sup>1)</sup>	(DA) Dial marking
				(15) G ½ B male		0/ 40			(EA) External zero adjustment
				Flange: (DN20) DN20		0/ 60			(EP) Maximum pointer, adjustable
				(DN25) DN25		0/ 100			(MP) Micrometer pointer
				(DN50) DN50		0/ 160			(NH) Tagging wired
				(10-150) 1" 150#		0/ 250			(PD) Acrylic glass
				(15-150) 1½" 150#		0/ 400			(SH) Red set hand stationary
				(10-300) 1" 300#		-1/ 0	BAR		
				(20-150) 2" 150#		-1/ 1,5			
				(30-150) 3" 150#		-1/ 3			
				(R50) Open flange DN50		-1/ 5			
						-1/ 9			
						-1/ 15			
						-1/ 24			
						0/ 0,6			
						0/ 1			
						0/ 1,6			
						0/ 2,5			
						0/ 4			
						0/ 6			
						0/ 10			
						0/ 16			
						0/ 25			
		<sup>1)</sup> not for vacuum and compound ranges	<sup>1)</sup> liquid filled only for ranges ≥ 100 mbar	others on request			psi and others on request	<sup>1)</sup> ranges ≤400 mbar only available with dial size 160 mm	Option listing starts with "X", followed by options separated by "-" Example: X=NH=SG=FW

## How to order

Size	Type	System material	Execution	Process connection	Connection orientation	Range	Engineering unit	Filling	Option
100	P5500	S	D	04	L	0/250	MBAR	=	NH

## Ashcroft Instruments GmbH

**Germany**  
 Max-Planck-Str. 1, D-52499 Baesweiler  
 P.O. Box 11 20, D-52490 Baesweiler  
 Tel.: +49 (0) 2401 808-0, Fax: +49 (0) 2401 808-125

**France**  
 48, Chemin des Landes  
 F-69700 Montagny  
 Tel.: +33 (0) 9 65 32 71 31, Fax: +33 (0) 4 72 39 10 57

Website: [www.ashcroft.eu](http://www.ashcroft.eu)

**United Kingdom**  
 Unit 17 & 18 William James House  
 Cowley Road, Cambridge CB4 0WX  
 Tel.: +44 (0) 12 23 39 55 00, Fax: +44 (0) 12 23 39 55 01

e-Mail: [sales@ashcroft.com](mailto:sales@ashcroft.com)