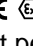

All stainless steel bimetal thermometer

Model A

Nominal size 100 mm or 160 mm
 Accuracy: Class 1 according to EN 13190

Features

- Rugged all welded stainless steel construction
- Protection IP66
- Optional ATEX approved **CE**  II 2 GD c Tx°C IP66
- Optional external adjustment permits zero reset from outside the case.
- Dry or liquid filled
- Silicone coil dampening provides vibration dampening and improves response time



Ranges

-50 ... 50 °C up to 0 ... 500 °C
 -80 ... 120 °F up to 200 ... 1000 °F

Applications

Chemical and petrochemical industry
 Machine and apparatus construction
 Food and beverage industry
 Pulp and paper industry

| Technical specification | | AM, AE, AI, A3B | | | | | | | | | | |
|--|--|--|--|--|--|--|--|--------|--|--|--|--|
| Dial size | | 100 mm | | | | | | 160 mm | | | | |
| Construction | | Cylindrical case with bayonet ring | | | | | | | | | | |
| Measuring principle | | Bimetallic coil | | | | | | | | | | |
| Range in °C | | 0/50 0/60 0/80 0/100 0/120 0/150 0/160 0/200 0/250 0/300 0/400 0/500 | | | | | | | | | | |
| Ranges in °F | | 10/150 50/300 50/450 100/500 | | | | | | | | | | |
| | | -10/50 -10/110 -20/40 -20/60 -20/80 -20/120 -20/180 | | | | | | | | | | |
| | | -25/25 -30/50 -30/70 -40/40 -40/60 -40/160 -50/50 | | | | | | | | | | |
| | | 0/100 0/150 0/200 0/250 0/300 0/350 0/500 20/120 30/130 30/240 | | | | | | | | | | |
| | | 50/300 50/400 50/550 80/180 100/800 160/360 170/270 200/400 200/700 200/1000 | | | | | | | | | | |
| Temperature limits for ranges | | Dual scales on request | | | | | | | | | | |
| | | < 120 °C ≥ 120 °C and < 290°C ≥ 290 °C | | | | | | | | | | |
| Max. process overtemperature | | 100 % of span 50 % of span max. 425 °C for continuous service | | | | | | | | | | |
| Max. ambient temperature | | 94 °C with dry case, 65 °C with liquid filling | | | | | | | | | | |
| Stem | | | | | | | | | | | | |
| Diameter | | 6 mm, 8 mm, ¼" (6,4 mm), 3/8" (9,6 mm) | | | | | | | | | | |
| Length | | 63 ... 1000 mm, minimum length depends on range | | | | | | | | | | |
| Process connection | | Plain G ½ A male, G ½ female, ½ NPT male or ½ NPT female G ¾ A male, G ¾ female, ¾ NPT male or ¾ NPT female, M18x1,5 male or M18x1,5 female G 1 A male, G 1 female, 1 NPT male or 1 NPT female, others on request Fixed, adjustable or with swivel nut | | | | | | | | | | |
| Connection location | | Back, lower and every angle (rotatable) | | | | | | | | | | |
| Material | | | | | | | | | | | | |
| Connection | | Stainless steel 316L (1.4404) or 1.4571 (316Ti) | | | | | | | | | | |
| Stem | | Stainless steel 316L (1.4404) or 1.4571 (316Ti) | | | | | | | | | | |
| Case/ring | | Stainless steel 304 (1.4301), optional 316L (1.4404) | | | | | | | | | | |
| Window | | Instrument glass, optional shatter proof glass or acrylic glass | | | | | | | | | | |
| Dial | | Aluminum, black markings on white background | | | | | | | | | | |
| Pointer | | Aluminum, black | | | | | | | | | | |
| Accuracy | | Class 1 | | | | | | | | | | |
| Protection according EN 60 529/IEC 529 | | IP66 | | | | | | | | | | |
| Conformity according to RL 2014/34/EU appendix X for mechanical equipment in potential hazardous areas | | Optional, Marking CE Ⓜ II 2 GD c Tx°C IP66; CE Ⓜ II 2 GD c Tx°C IP65 (for bimetal with external zero adjustment) Ta -20°C ... 60°C File no. 35088073 at notified body 0044, TUV NORD CERT (only with shatter proof glass and protection IP66) | | | | | | | | | | |
| Filling liquids | | Silicone, not for lower connection, acrylic glass is standard Maximum range up to 300 °C | | | | | | | | | | |
| Weight in kg | | | | | | | | | | | | |
| Connection location | | | | | | | | | | | | |
| Dry | | | | | | | | | | | | |
| Filled | | | | | | | | | | | | |
| Accessories | | Thermowells must be used on all pressure or velocity applications, to protect the stem of thermometer from corrosion and physical damage, and to facilitate removal of the thermometer without disturbing the process. | | | | | | | | | | |

All specifications are subject to change without notice.

Detailed specification and general dimensions of process connection

Union outlet code 042

Length S is fixed, but orientation can be adjusted with union connection.
 Code 042 ½ NPT male

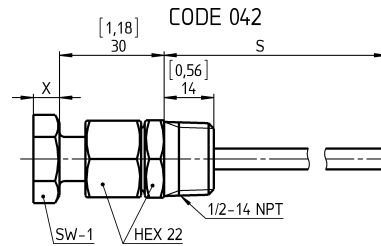

| CODE 042 | SW-1 | X |
|----------|------|------------|
| L | 24 | 8 [0,31] |
| E | 22 | 9,8 [0,39] |
| R | 22 | 7,5 [0,30] |

Fixed connection code 060 and 061

Length S is fixed.
 Code 060 ½ NPT male
 Code 061 G ½ A male

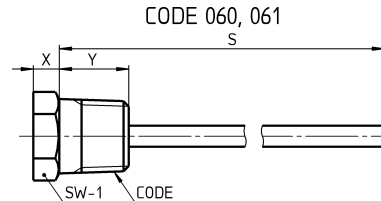

| CODE 060 1/2-14 NPT | SW-1 | X | Y |
|------------------------------|------|------------|-----------|
| L | 24 | 8 [0,31] | 20 [0,79] |
| E | 22 | 9,8 [0,39] | 20 [0,79] |
| R | 22 | 7,5 [0,30] | 20 [0,79] |
| CODE 061 G 1/2 A L/E/R | 27 | 12 [0,47] | 12 [0,47] |

Adjustable union connection code 070, 071 and 072, 089

Length S and orientation can be adjusted with union connection.
 Code 070 ½ NPT male
 Code 071 G ½ A male
 Code 072 ¾ NPT male
 Code 089 M18x1,5 male

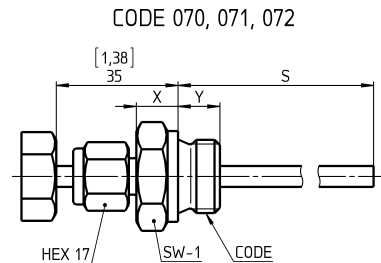

| L/E/R | SW-1 | X | Y |
|------------------------|------|------------|-----------|
| CODE 070 1/2-14 NPT | 22 | 7,5 [0,30] | 20 [0,79] |
| CODE 071 G 1/2 A | 27 | 12 [0,47] | 12 [0,47] |
| CODE 072 3/4-14 NPT | 27 | 9 [0,35] | 20 [0,79] |

Adjustable union connection code 074, 096

Length S and orientation can be adjusted with swivel nut.
 Code 074 ½ NPT female
 Code 096 M18x1,5 female

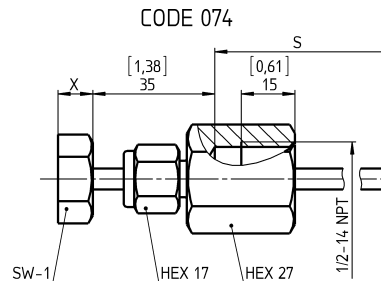

| CODE 074 | SW-1 | X |
|----------|------|------------|
| L | 24 | 8 [0,31] |
| E | 22 | 7,5 [0,30] |
| R | 22 | 10 [0,39] |

Swivel nut connection code 080, 066

Length S is fixed, but orientation can be adjusted with swivel nut.
 Code 080 G ½ A male
 Code 088 M18x1,5 male

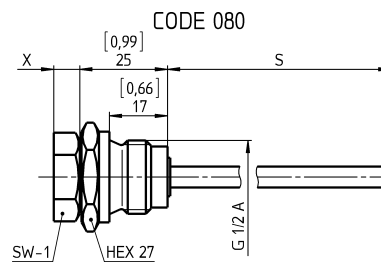

| CODE 080 | SW-1 | X |
|----------|------|------------|
| L | 24 | 8 [0,31] |
| E | 22 | 7,5 [0,30] |
| R | 22 | 7,5 [0,30] |

Swivel nut connection code 081

Length S is fixed, but orientation can be adjusted with union connection.
 Code 081 G ½ female

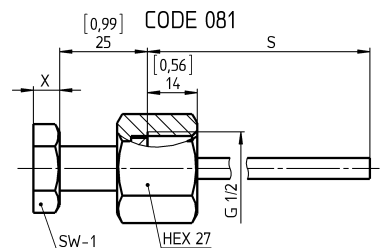

| CODE 081 | SW-1 | X |
|----------|------|------------|
| L | 24 | 8 [0,31] |
| E | 22 | 7,5 [0,30] |
| R | 22 | 7,5 [0,30] |

Ashcroft Instruments GmbH

Germany
 Max-Planck-Str. 1, D-52499 Baesweiler
 P.O. Box 11 20, D-52490 Baesweiler
 Tel.: +49 (0) 2401 808-0, Fax: +49 (0) 2401 808-125

France
 48, Chemin des Landes
 F-69700 Montagny
 Tel.: +33 (0) 9 65 32 71 31, Fax: +33 (0) 4 72 39 10 57

Website: www.ashcroft.eu

e-Mail: sales@ashcroft.com

United Kingdom

Unit 17 & 18 William James House
 Cowley Road, Cambridge CB4 0W X
 Tel.: +44 (0) 12 23 39 55 00, Fax: +44 (0) 12 23 39 55 01