

Pipe connectors

Straight pipe

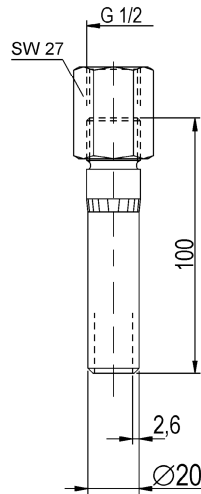

Elbow 90°

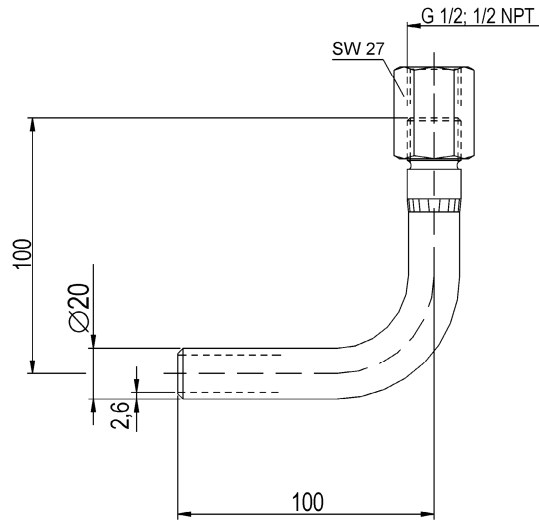

- 1 steel type
- 2 stainless steel type

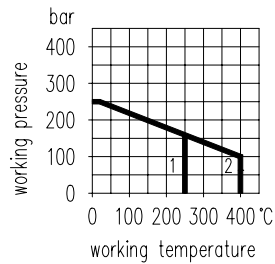

Connection thread d	Material	Part no.	
		Straight pipe	Elbow 90°
G 1/2	Steel	51-PC01-SC-STR	51-PC01-SC-EL
	St. st.	51-PC01-SS-STR	51-PC01-SS-EL
½ NPT	Steel	50-PC01-SC-STR	50-PC01-SC-EL
	St. st.	50-PC01-SS-STR	50-PC01-SS-EL

Components	Steel	Stainless steel
	DIN-Material Number	
Tube 20 x 2,6 mm	St 35.8	316Ti (1.4571)
Adjusting nut	acc. to DIN 16 283	

- Surface: steel phosphatized
- Range of application:
For liquids, gas or steam
- Other materials, pressure/temperature ratings and connections on request